

## Technical Information

The Predator GC12-DT1275-105 is an industrial deep cycle battery designed specifically for golf cart, scissor lift, floor scrubber and similar motive power applications.

This battery features enhanced SiO<sub>2</sub> – PVC Nano Grade separators for maximum performance and durability.

The proprietary design caps are have been developed to minimise water loss during use.

### Charging

Charge Voltage: 14.7-15V

Float Voltage: 13.0V

Recommended Charge Current: 15A

Maximum Charge Current: 37.5A

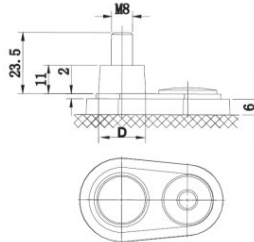
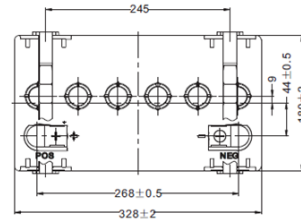
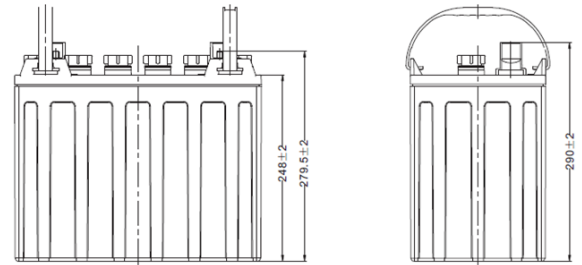

## Features & Benefits

- Thick plates for dimensional stability
- Optimised for high cycle motive applications
- Proprietary alloy and paste composition
- Cap design reduces water consumption
- High conductivity terminals

Terminal		
D	Positive	19.5 <sup>±0.3</sup>
	Negative	17.9 <sup>±0.3</sup>

## Applications

Golf Carts

Scissor Lifts & Floor Scrubbers

Off Grid Power Storage

## Technical Specifications

<b>Battery Type</b>	Lead Antimony Deep Cycle	<b>Case Material / Colour</b>	Polypropylene / Black
<b>Voltage</b>	12V	<b>Lid Type / Colour</b>	Accessible / Black
<b>Capacity (20Hr / 5Hr)</b>	150Ah / 120Ah	<b>Plate Type</b>	Cast Grids
<b>Reserve Capacity (25A)</b>	280 minutes	<b>Separator Type</b>	SiO <sub>2</sub> – PVC Nano Grade
<b>Reserve Capacity (56A)</b>	102 minutes	<b>Assembly Layout</b>	LH Positive [+ -]
		<b>Terminal Type</b>	DT - M8 (UTL)
<b>Overall Size (LxWxH)</b>	328 x 180 x 279.5mm	<b>Case Size</b>	BCI GC12
<b>Nominal Weight</b>	35.7kg	<b>Ledges</b>	None