



## LITHIUM IRON PHOSPHATE BATTERY

### ELECTRICAL SPECIFICATIONS

Nominal Voltage	12.8 V
Nominal Capacity	35 Ah
Capacity @ 25A	84 min
Energy	448 Wh
Resistance	50 mΩ
Efficiency	99%
Self Discharge	<3% per Month
Maximum Modules in Series	1

### DISCHARGE SPECIFICATIONS

Maximum Continuous Discharge Current	70 A
Peak Discharge Current	100 A (7.5 s ±2.5 s)
PCM Discharge Current Cut-Off	160 A (±20 A)
Recommended Low Voltage Disconnect	11 V
PCM Discharge Voltage Cut-Off	8 V
Reconnect Voltage	7.7 - 9.6 V
Short Circuit Protection	200-800 μs

### TEMPERATURE SPECIFICATIONS

Discharge Temperature	-4 to 140 °F (-20 to 60 °C)
Charge Temperature	32 to 131 °F (0 to 55 °C)
Storage Temperature	-4 to 140 °F (-20 to 60 °C)
PCM High Temperature Cut-Off	167 °F (75 °C)

### DIMENSIONAL SPECIFICATIONS

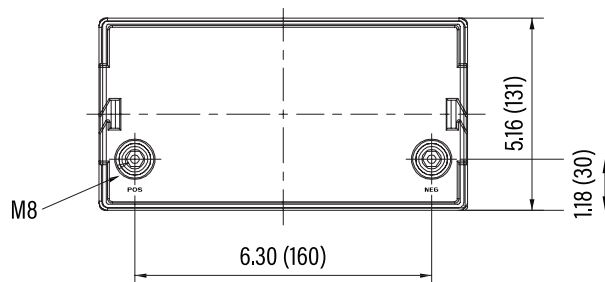

### MECHANICAL SPECIFICATIONS

Dimensions (L x W x H)	7.7 x 5.2 x 6.7"
	195 x 131 x 171 mm
Weight	11.4 lbs (5.17 kg)
Terminal Type	M8
Terminal Torque	80 - 100 in-lbs (9 - 11 N-m)
Case Material	ABS
Enclosure Protection	IP56
Cell Type - Chemistry	Cylindrical - LiFePO <sub>4</sub>

### CHARGE SPECIFICATIONS

Recommended Charge Current	17.5 A
Maximum Charge Current	70 A
PCM Charge Current Cut-Off	160 A (±20 A)
Recommended Charge Voltage	14.2 V - 14.6 V
PCM Charge Voltage Cut-Off	15.6 V
Reconnect Voltage	15.2 V
Balancing Voltage	14.4 V

### COMPLIANCE SPECIFICATIONS

Certifications	CE (battery) UL1642 & IEC62133 (cells)
Shipping Classification	UN 3480, CLASS 9

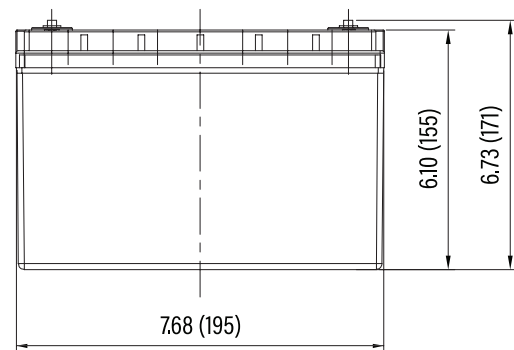



### PERFORMANCE CHARACTERISTICS

